

THE CITY OF NAPOLEON

BUILDING & ZONING DEPARTMENT

255 W. RIVERVIEW

(419)592-4010

Building Permit

Page 1 of 2

Permit Number: BP2009-10

Printed: 4/7/2009

ADDRESS:

1435 Oakdale

Applicant

Name: Mock Buehrer Builders

Address: P-707 Co. Rd. 16

Approval Date: 3/19/2009

419-592-0825

Owners

Name: Bruce Hastedt

Address: 1435 Oakdale

Napoleon, OH 43545

Phone: 419-592-3718

Contractors

Contractor Type: General Contractor

Name: Mock Buehrer Builders

Address: P-707 Co. Rd. 16

Napoleon, OH 43545

Phone: 419-592-0825

Contractors

Contractor Type: Electrician

Name: Tom Speiser Electric

Address: P685 Co Rd 15

Napoleon, OH 43545

Phone: 419-592-4125

Fees and Receipts:

Number	Description	Amount
FEE2009-166	Building Permit Fee (Auto)	\$44.00
FEE2009-167	State 1% fee (Calc)	\$0.44

Total Fees: \$44.44

RCPT2009-184 \$44.44

Total Receipts: \$44.44

18 x 20 addition

APPLICANTS SIGNATURE: _____ DATE: _____

CITY OF NAPOLEON GENERAL PERMIT APPLICATION

BoEh #20459

THIS APPLICATION IS FOR RESIDENTAL CONSTRUCTION INCLUDING BUILDING, ELECTRICAL, PLUMBING, MECHANICAL, DEMOLITIONS, & REMODELING.

check 8963

04-01-09

DATE: 2-17-09 JOB LOCATION: 1435 OAK DALE

OWNER: BRUCE HASTEDT PHONE: 592-3718

OWNER ADDRESS: 1435 OAK DALE CITY: NAP. ZIP: 43545

CONTRACTOR: MOCK - BUEHRER BUILDERS

PHONE #: 592-0825 CELL PHONE#: 392-6189

CONTRACTOR LICENSED WITH THE CITY OF NAPOLEON? YES NO:

Is any of the above job going to be subcontracted out? Yes No:

If yes to whom: TOM SPIESER ELE.

DESCRIPTION OF WORK TO BE PERFORMED: 18' x 20' ADDITION

ESTIMATED COMPLETION DATE: 4-1-09

PLEASE MARK THE TYPE OF WORK YOU WILL BE PERFORMING

- | | |
|--|---|
| <input type="checkbox"/> A/C ADD ON 1% | <input type="checkbox"/> REMODELING 1% |
| <input type="checkbox"/> BOILER REPLACEMENT 1% | <input type="checkbox"/> ROOFING 1% |
| <input type="checkbox"/> CURBING | <input type="checkbox"/> SEWER REPAIRS** |
| <input type="checkbox"/> DECKS * 1% | <input type="checkbox"/> SIDEWALK* |
| <input type="checkbox"/> DRIVEWAY* | <input type="checkbox"/> SIDING 1% |
| <input type="checkbox"/> ELECTRICAL SERVICE UPGRADE 1% | <input type="checkbox"/> SHED* (under 200 sq ft) |
| <input type="checkbox"/> ELECTRICAL SERVICE NEW 1% | <input type="checkbox"/> SHED* (over 200 sqft) 1% |
| <input type="checkbox"/> SWIMMING POOL* 1% | <input type="checkbox"/> FENCE* |
| <input type="checkbox"/> FURNACE REPLACEMENT 1% | <input type="checkbox"/> TEMP ELECTRIC 1% |
| <input checked="" type="checkbox"/> ADDITIONS* 1% | <input type="checkbox"/> FURNACE NEW 1% |
| <input type="checkbox"/> WATER TAP (size _____") | <input type="checkbox"/> WINDOWS /DOORS 1% |
| <input type="checkbox"/> LAWN METER 1% | |
| <input type="checkbox"/> PLUMBING 1% | |

1%- EFFECTIVE JUNE 1, 2007 BOARD OF BUILDING STANDARDS FEE

*PLEASE INCLUDE A PICTURE SHOWING MEASUREMENTS FROM EXISTING STRUCTURES AND PROPERTY LINES. INDICATING THE TYPE OF WORK YOU WISH TO PERFORM.

** IF WORK REQUIRES GOING INTO THE STREET A STREET BOND IS REQUIRED!

FOR PERMIT COSTS PLEASE FILL OUT REVERSE SIDE.

OFFICE USE ONLY

PERMIT# _____

DUE: \$ _____

PERMIT COST WORKSHEET

1%

JOB _____ **BASE FEE** _____ **TOTAL + BBS FEE = PERMIT TOTAL** _____

SIDING (only) TOTAL SQ _____ X 1.00 = _____ + \$5.00 = \$ _____ + \$ _____ = \$ _____			
ROOFING (only) TOTAL SQ _____ X 1.00 = _____ + \$5.00 = \$ _____ + \$ _____ = \$ _____			
WINDOWS / DOORS(only) # _____ X 1.00 = _____ + \$5.00 = \$ _____ + \$ _____ = \$ _____			
ELECTRICAL # OF CIRCUITS <u>1</u> X 3.00 = <u>3</u> + \$15.00 = \$ <u>18.00</u> + \$ <u>.18</u> = \$ <u>18.18</u>			
ELECTRICAL SERVICE UPGRADE	\$15.00 = \$ _____	+ \$ _____	= \$ _____
PLUMBING (INSIDE) replacing/ repairs	\$10.00 = \$ _____	+ \$ _____	= \$ _____
SEWER (OUTSIDE)	\$25.00 =	\$ N/A	= \$ _____
WATER HEATER	\$5.00 = \$ _____	+ \$ _____	= \$ _____
SHED UNDER 200 SQ FT (over 200 see chart)	\$ 5.00 =	\$ N/A	= \$ _____
FURNACE OR A/C (REPLACMNT)	\$ 5.00 = \$ _____	+ \$ _____	= \$ _____
DEMOLITION (only)	\$30.00	N/A	\$ _____
SIDEWALK REPLACEMENT/ NEW	\$25.00	N/A	\$ _____
DRIVEWAY	\$25.00	N/A	\$ _____

ALL CONSTRUCTION, ALTERATIONS, REMODELING, SHEDS, DECKS, & FENCES NOT LISTED ABOVE IS BASED ON COST OF WORK BEING PERFORMED.D.

COST OF WORK \$ 30000.00 PERMIT FEE (SEE CHART) \$ 44.00 + \$.44 = \$ 4444

0.00	-	250.00	0.00	11,000.00	-	11,999.00	25.00
250.00	-	999.00	10.00	12,000.00	-	12,999.00	26.00
1,000.00	-	1,999.00	12.00	13,000.00	-	13,999.00	27.00
2,000.00	-	2,999.00	14.00	14,000.00	-	14,999.00	28.00
3,000.00	-	3,999.00	16.00	15,000.00	-	15,999.00	29.00
4,000.00	-	4,999.00	18.00	16,000.00	-	16,999.00	30.00
5,000.00	-	5,999.00	19.00	17,000.00	-	17,999.00	31.00
6,000.00	-	6,999.00	20.00	18,000.00	-	18,999.00	32.00
7,000.00	-	7,999.00	21.00	19,000.00	-	19,999.00	33.00
8,000.00	-	8,999.00	22.00	20,000.00	-	20,999.00	34.00
9,000.00	-	9,999.00	23.00	21,000.00	-	21,999.00	35.00
10,000.00	-	10,999.00	24.00	22,000.00	-	22,999.00	36.00
				Over 22,999		Please Call	

** OTHER FEES NOT LISTED MAY APPLY

TOTAL PERMIT COSTS \$ _____

OAKDALE DR.

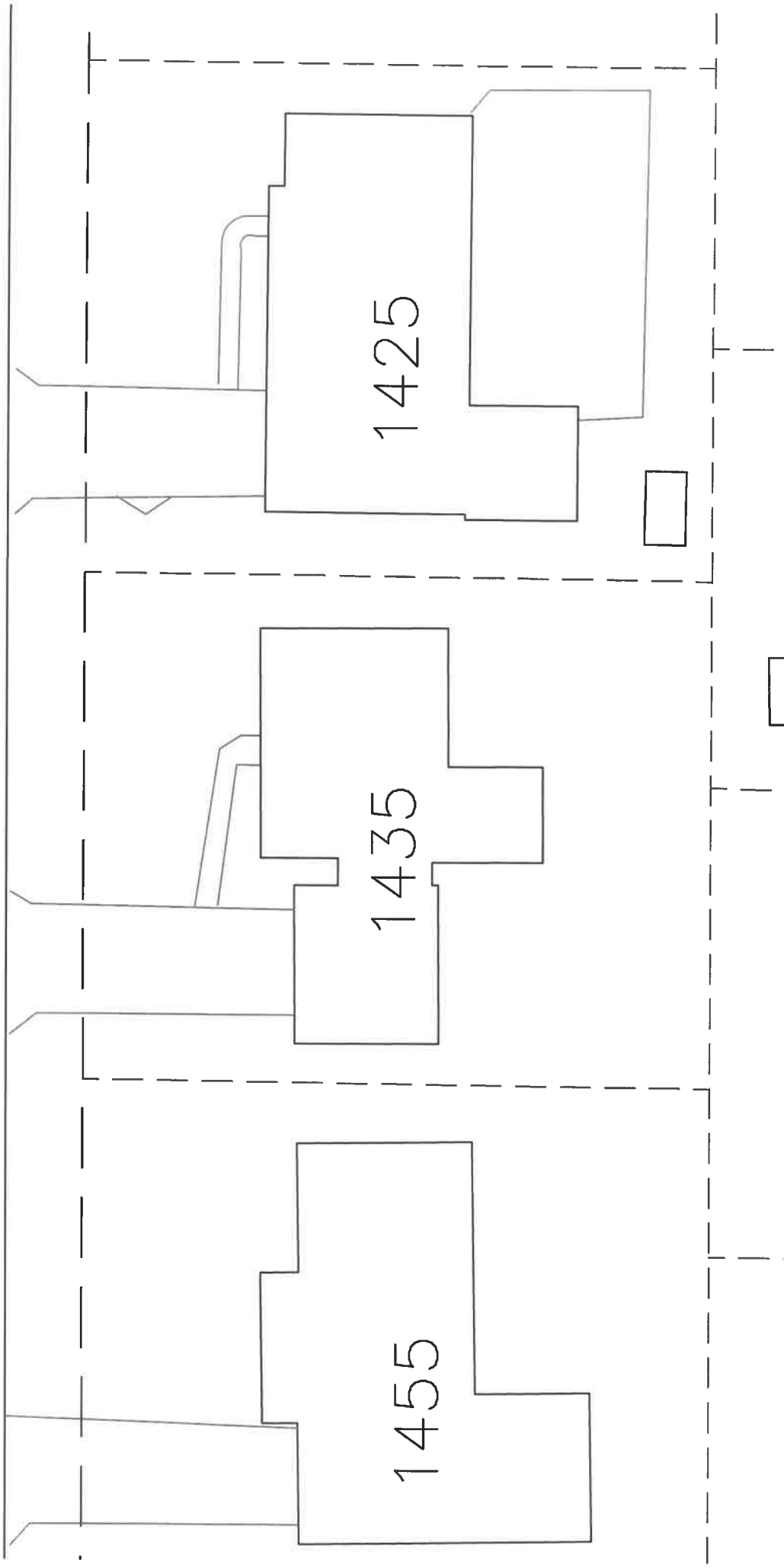

1425

1435

1455

313

THE CITY OF NAPOLEON

BUILDING & ZONING DEPARTMENT

255 W. RIVERVIEW

(419)592-4010

Electrical Permit

Page 1 of 1

Permit Number: EL2009-3

Printed: 4/7/2009

ADDRESS:

1435 Oakdale

Applicant

Name: Tom Speiser Electric
Address: P685 Co Rd 15

Approval Date: 3/19/2009
419-592-4125

Owners

Name: Bruce Hastedt
Address: 1435 Oakdale
Napoleon, OH 43545

Phone: 419-592-3718

Contractors

Contractor Type: Electrician
Name: Tom Speiser Electric
Address: P685 Co Rd 15

Napoleon, OH 43545

Phone: 419-592-4125

Fees and Receipts:

Number	Description	Amount
FEE2009-169	circuits (Auto)	\$18.00
FEE2009-170	State 1% fee (Calc)	\$0.18
Total Fees:		\$18.18
RCPT2009-185		\$18.18
Total Receipts:		\$18.18

18 x 20 Addition

APPLICANTS SIGNATURE: _____ **DATE:** _____

REMINDER: YOU MUST CALL (419)592-4010 FOR AN INSPECTION

SCANNED

